

Rachana Anandvan



Corporate Office

Architects : Ulhas Mude & Associates ■ Structural Engineer : P. S. Patankar ■ Landscape Consultant : Mahesh Chinchalkar, Pune.



Rachana Construction Co. (Nag) Pvt. Ltd.

(An ISO 9001-2008 Certified Company) Working Hours: 9.30am to 7pm (Mon to Sat.)

"Lotus" 4th Floor, W.H.C.Road, Between Law College & Coffee House Square, Dharampeth, Nagpur - 440010,
Ph.: No. 0712-2022722, 2022591, Web site: www.rachanaconstructions.com, e-mail: info@rachanaconstructions.com
Branch office at Pune: Block 404, 4th Floor, "Stellar Enclave", Plot No.10 (Above Mc'donald's), D. P. Road, Near Parihar Square, Pune

Note : This brochure is an imaginary concept & artists impression. Plan is not to scale and furniture layout is just an indication. Contents of this brochure do not form part of an offer or contract. Cost of the flat does not include legal fee, stamp duty, registration fee, electrification/water connection charges, maintenance deposit and all govt. Levies applicable on sale of apartments which shall be payable extra on demand.

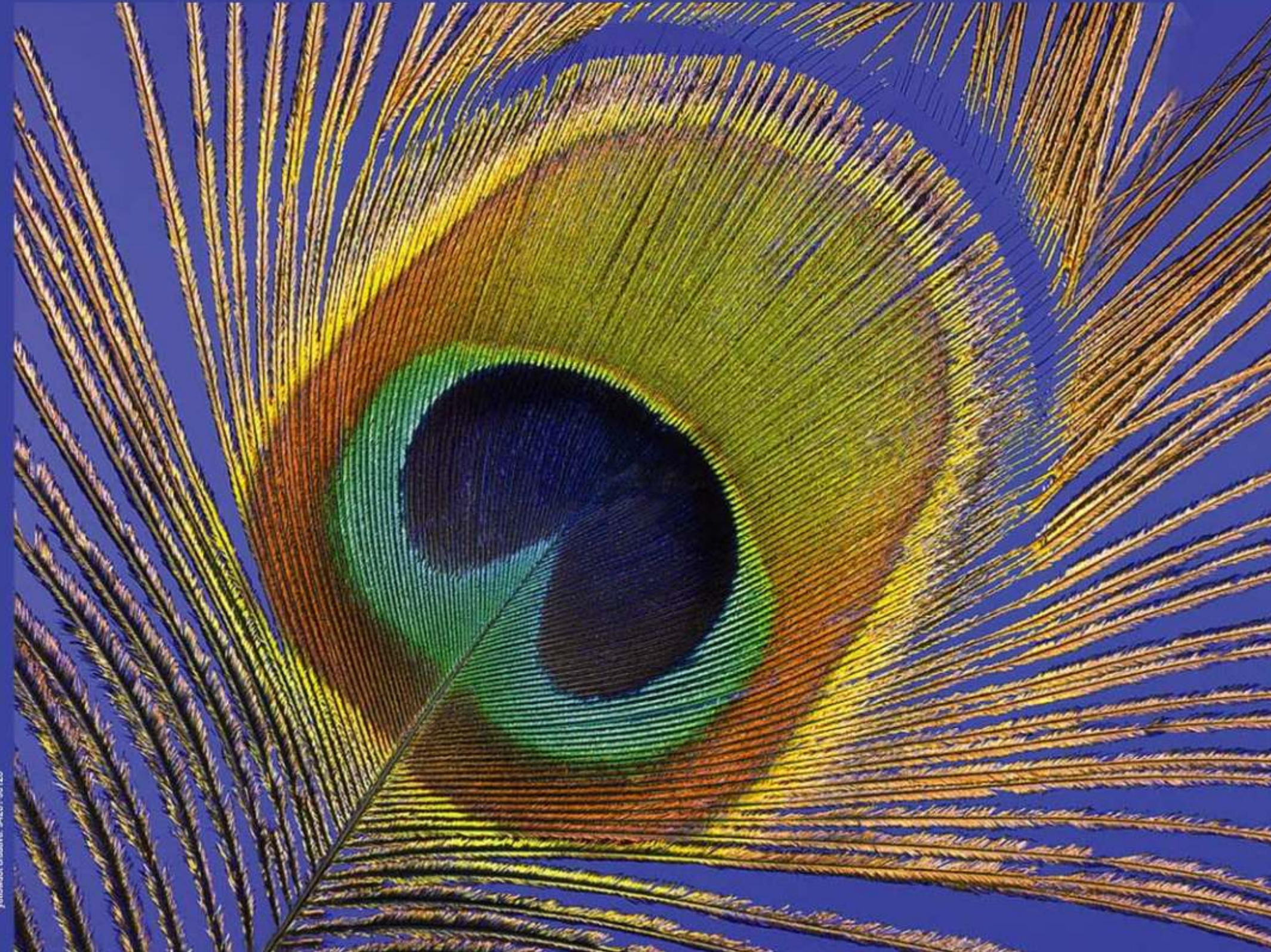

Rachana
Anandvan



A Scheme of 2 BHK Flats



"Rachana Construction Co. (Ngp) Pvt. Ltd"

(An ISO 9001-2008 Certified Company)

is promoted by **Shri. Shishir Diote**, Managing Director,

a Civil Engineer with over 20 years of experience in the field of Civil Construction,
who looks after all the Technical and Financial affairs of the Company.

Smt. Nilima Diote, (B.Tech, DBM) is the Executive Director.

She has vast experience in Construction Industry and looks after Marketing,
Material Procurement and General Administration of the Company.

They have to their credit successful completion of over 65 Projects
of various Magnitudes. They are ably supported by a Team of Professionals

who look after Meticulous Planning, Quality Construction,

Proper Legal Documentation, Suitable Advise to Clients

and Satisfactory after Sale Service. Company has a High Rating with

all Leading Housing Finance Institutions and Banks



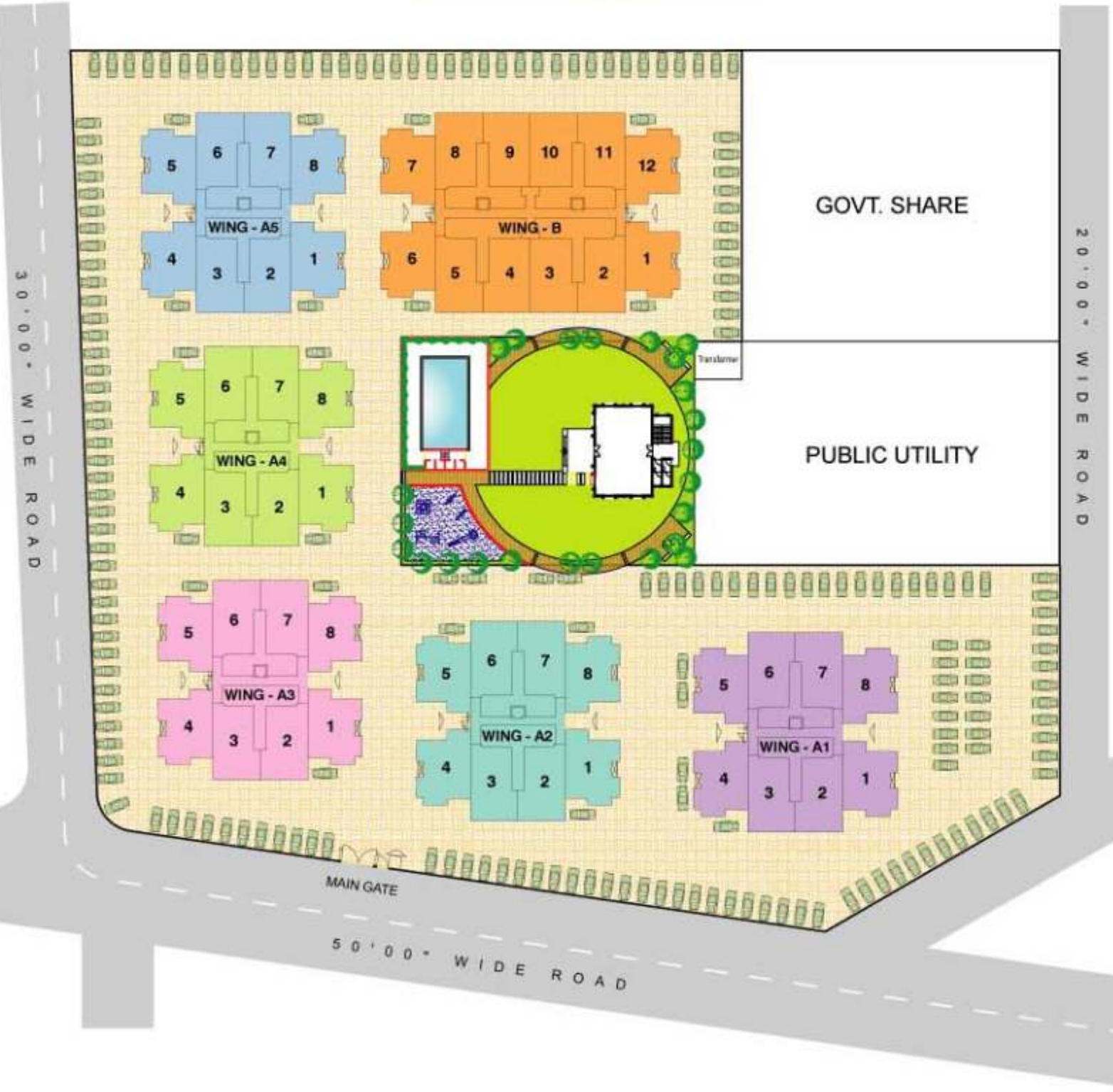

LAYOUT PLAN

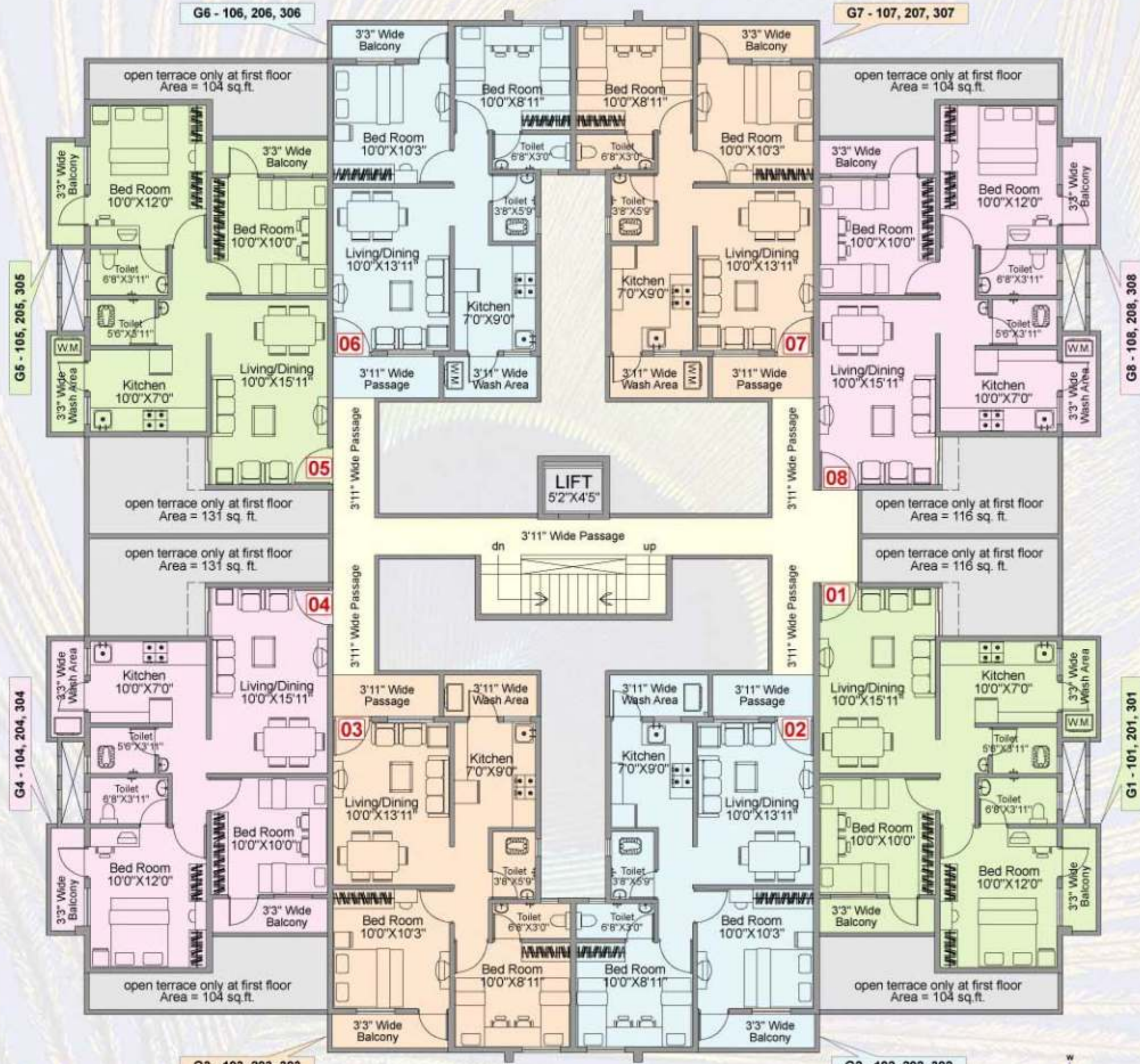

Ground Floor To Third Floor Plan

WING A1, A2, A3, A4 & A5

Note: Adjacent Open Terrace shown in Grey colour is only at First Floor



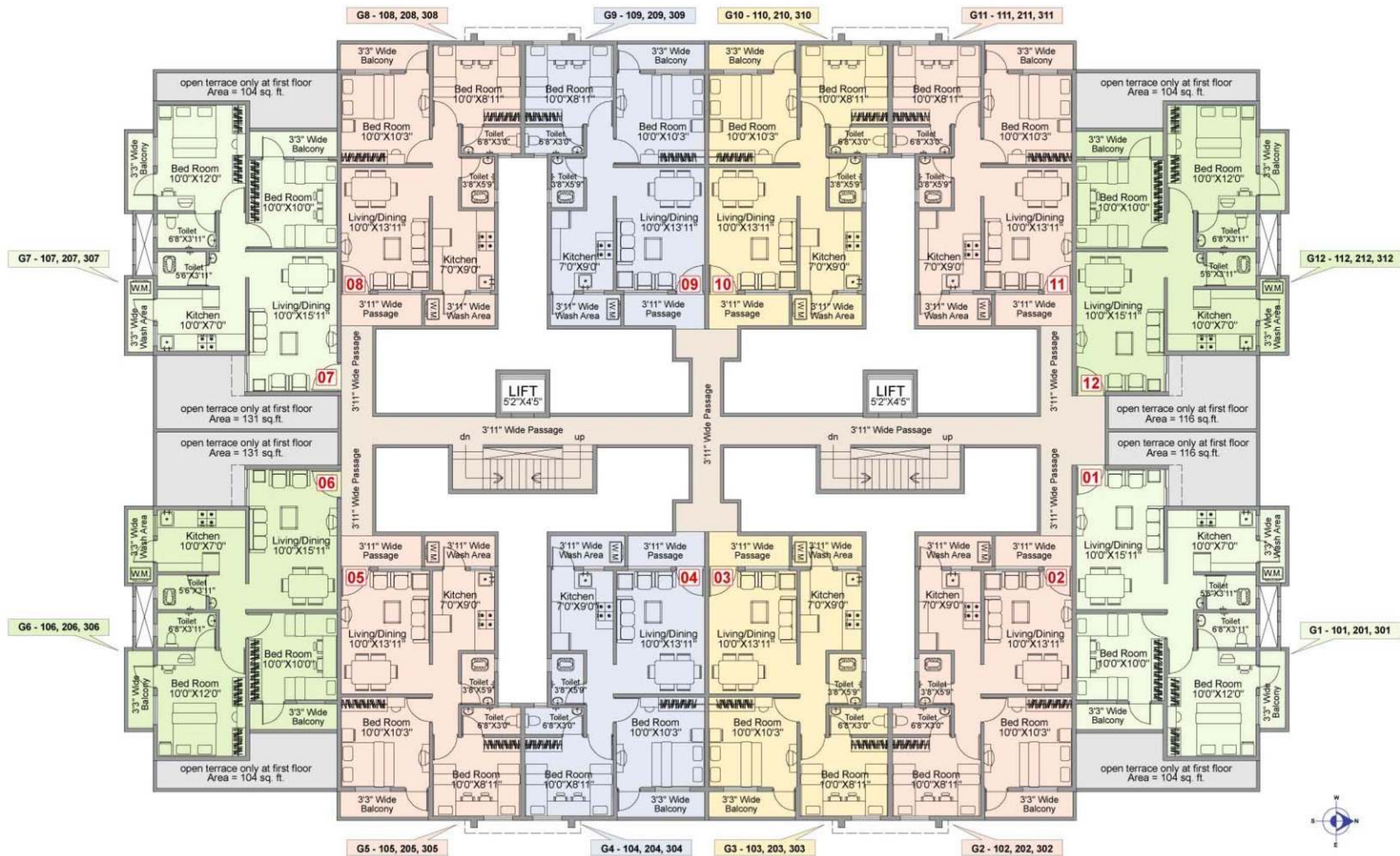

Ground Floor To Third Floor Plan

Note: Adjacent Open Terrace shown in Grey colour is only on First Floor

WING - B



Specifications

Structure	: R.C.C. Framed Structure
Walls	: Outer walls shall be 6" thick & Internal walls shall be 4" thick.
Plaster	: Plain plaster for external walls & smooth funty finish for all internal walls.
Flooring	: All rooms & balconies with ceramic tile flooring.
Glazed Tiles	: Will be provided upto 2' for Kitchen Platform / Wash Basin & upto lintel level in Toilets.
Painting	: Outer walls with waterproof cement based paint & Internal walls shall be of putty finish with oil Bound Distemper Paint.
Doors	: Front Main Door: Wooden Frame with Laminated Flush door. Internal Doors: R.C.C.Frame with painted flush door panel.
Windows	: Aluminium windows with M. S. Grill.
Kitchen Otta	: Marble Platform with Stainless Steel sink.
Electrification	: 3 1/2 Points in each room. Two extra power points for Refrigerator & Gyser. T.V. & Telephone points in living room.
Plumbing	: Internal concealed fittings.

Amenities

- Fully Equipped Gym
- Landscaped Garden
- Children's play area with equipments
- Party Lawn
- Swimming Pool with Pool Side Party Deck
- Club House
- Temple
- Grand Entrance Gate with 24 Hrs. Security
- Senior Citizen Sit-out Area
- Lift with Power back up
- One Car Park Space for each Flat





Location Map

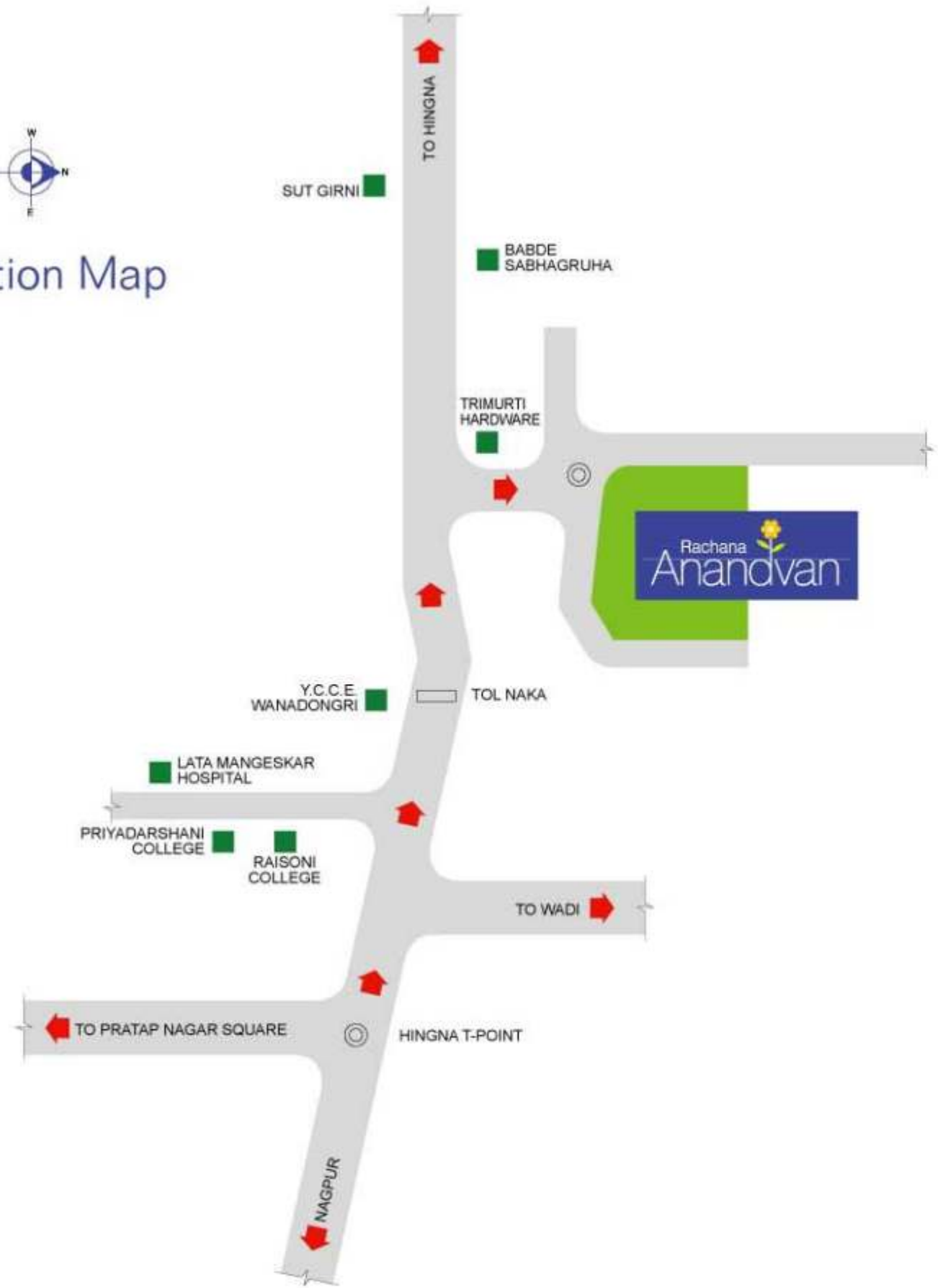

Schemes Completed Since 2000

Completed projects at Nagpur

- Shree Apartments
- Meher Apartments
- Rachana Shelter
- Rachana Classic
- Rachana Mathura
- Rachana Gharkul
- Rachana Surabhi
- Rachana Vihar
- Rachana Midas
- Rachana Vatika
- Rachana Gokul
- Rachana Govind
- Rachana Angan
- Rachana Tarangan
- Rachana Madhuban
- Rachana Vishwa
- Rachana Jheel
- Rachana Srushti
- Rachana Lotus
- Rachana Galaxy
- Rachana Vrundavan
- Rachana Sahil
- Rachana Rutuparna

Completed projects at Pune

- Rachana Chaitraban
- Rachana Durvankur
- Rachana Zephyr

Projects under construction at Nagpur

- Rachana Sayantara
- Rachana Madhukosh
- Rachana Anandvan



Rachana Sayantara - A Scheme of 2-3-4 BHK Flats and Row Houses.
Phase - I Nearing Completion & Phase - II Being Launched Soon.



Rachana Madhukosh (Under Construction)
Near Swawlambi Nagar