



Corporate Office

Architect: Ulhas Mude & Associates
Structure: P. S. Patankar
Landscape: Mahesh Chinchalkar



Rachana Construction Co. (Nag) Pvt. Ltd.

(An ISO 9001-2008 Certified Company) Working Hours: 9.30am to 7pm (Mon to Sat.)

"Lotus" 4th Floor, W.H.C.Road, Between Law College & Coffee House Square, Dharampeth, Nagpur - 440010, Ph.No. 0712-2022722, 2022591
Branch office at Pune: Block 404 , 4th Floor, "Stellar Enclave", Plot No.10 (Above Mc'donald's), D. P. Road, Near Parihar Square, Pune

Note : This brochure is an imaginary concept & artists impression. Plan is not to scale and furniture layout is just an indication. Contents of this brochure do not form part of an offer or contract. Cost of the flat does not include legal fee, stamp duty, registration fee, electrification/water connection charges, maintenance deposit and all govt. Levies applicable on sale of apartments which shall be payable extra on demand.

Rachana Madhukosh

Rachana

Maahukosh



"Rachana Construction Co. (Ngp) Pvt. Ltd"

(An ISO 9001-2008 Certified Company)

is promoted by

Shri. Shishir Diote, Managing Director,

a Civil Engineer with over 20 years of experience in the field of Civil Construction, who looks after all the Technical and Financial affairs of the Company.

Smt. Nilima Diote, (B.Tech, DBM) is the Executive Director.

She has vast experience in Construction Industry and looks after Marketing, Material Procurement and General Administration of the Company. They have to their credit successful completion of over 65 Projects of various Magnitudes. They are ably supported by a Team of Professionals who look after Meticulous Planning, Quality Construction, Proper Legal Documentation, Suitable Advise to Clients and Satisfactory after Sale Service. Company has a High Rating with all Leading Housing Finance Institutions and Banks





Rachana
Maqdhukosh

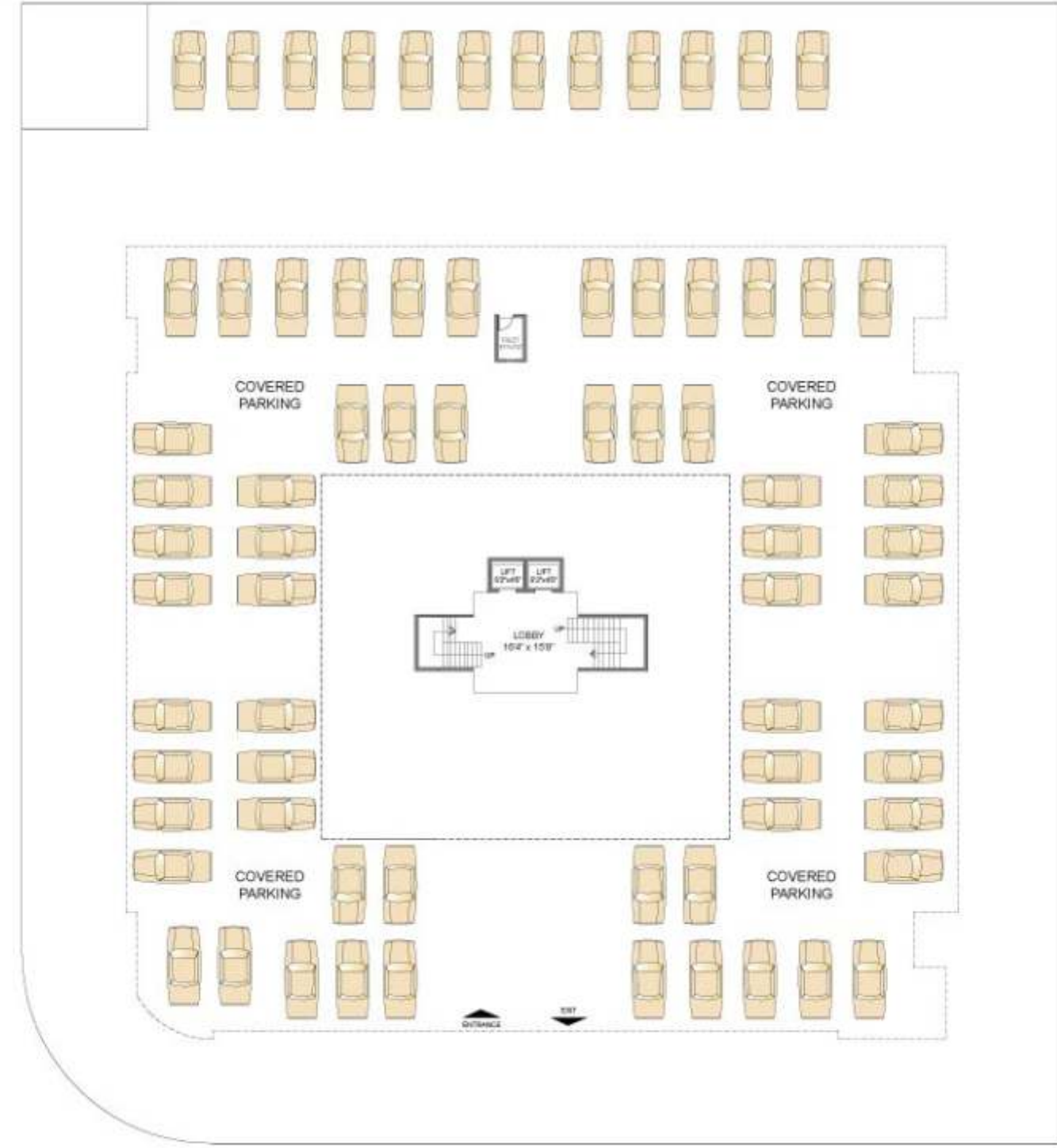

Ground Floor Parking Plan

First Floor Plan

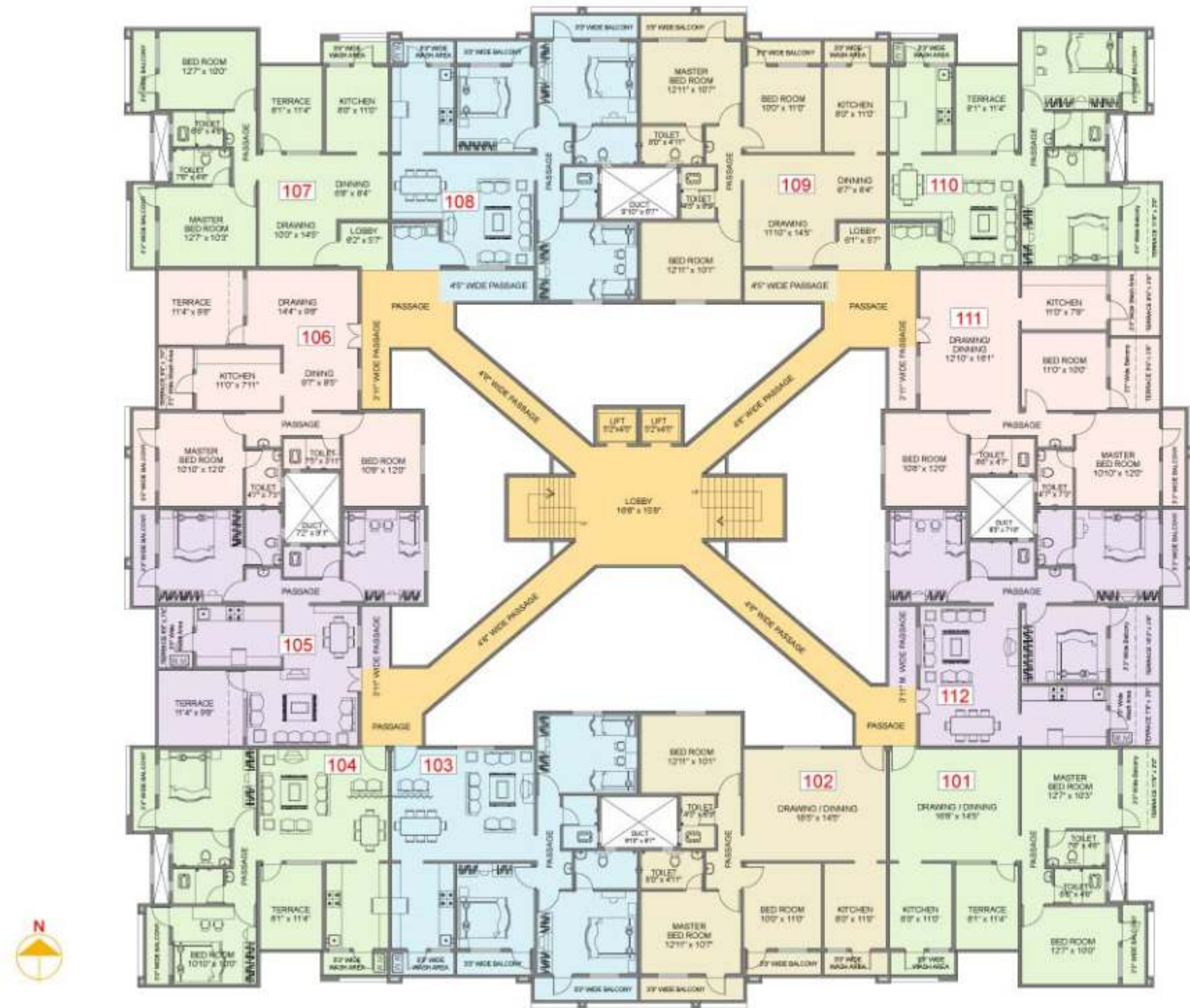

Second to Sixth Floor Plan

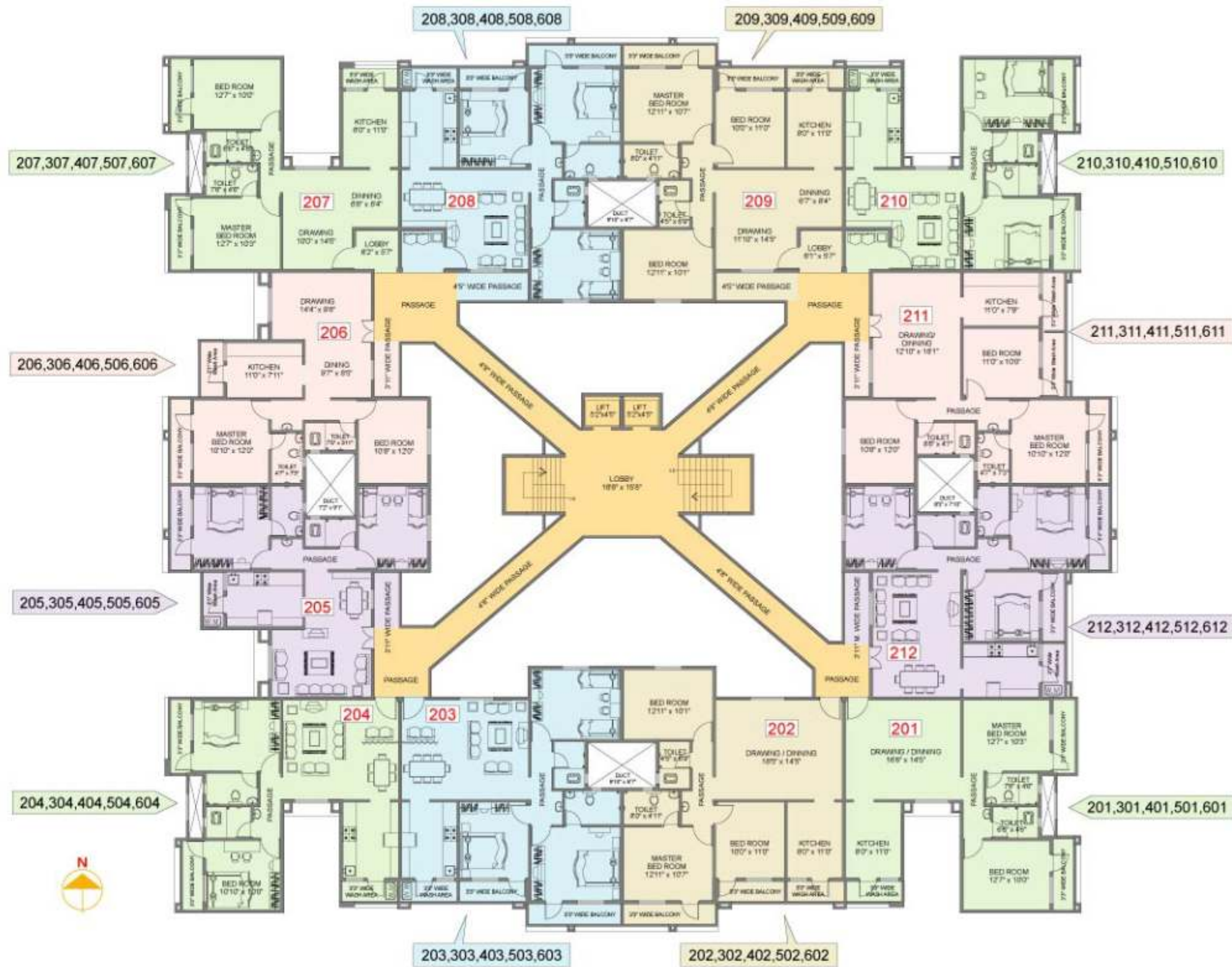

- Gymnasium
- Landscaped Garden
- Party Lawn
- Multipurpose Hall
- Swimming Pool
- Temple
- 2 Lifts of International Brand
- Power Back for Common Lighting and one Lift
- Provision for Fire Fighting Arrangements.
- Allotted Car Parking Space
- Rest room for drivers/servants
- Provision for 24 hours Security
- Intercom Facility for Communication from Flat to Flat and from Flat to Security Cabin and vice-versa
- Club House Terrace at II Floor for Yoga & Aerobics



STRUCTRE	: R.C.C. Framed structure.
BRICK WORK	: External walls 150 mm thick and internal walls 115 mm thick.
PLASTER	: Plain plaster for external walls and smooth funty finish for all Internal walls.
PAINTING	: External wall shall have exterior emulsion and internal walls shall be of oil bound distemper on smooth putty finish.
FLOORING	: Vitrified Tiles flooring to all rooms. Balcony and adjoining terraces shall have Ceramic Tiles flooring. Anti-skid ceramic tiles for toilets/bathrooms.
DOOR FRAMES	: Wooden frame for all doors.
DOOR SHUTTERS	: Front door shall be of decorative laminated solid core shutter and all other doors shall be solid core flush type shutter laminated.
WINDOWS	: Powder coated aluminium sliding windows with glass panels and M.S. grills.
GLAZED TILES	: Shall be provided upto 3 ft height above kitchen otta, upto lintel level for wash basin and in toilets
KITCHEN OTTA	: Modular kitchen otta with black granite top and stainless steel sink.
SANITARYWARE	: Washbasin, Commode/Orissa pan.
PLUMBING	: Internal concealed fittings.
ELECTRIFICATION	: Concealed ISI mark wiring with required electrical points to all rooms. One refrigerator point in kitchen, one geyser point in bathroom and one concealed TV, cable and telephone point shall be provided in drawing room.
WATER PROOFING	: Special water proofing treatment to toilets and top floor terraces.
EARTHQUAKE	: Structure designed to withstand earthquake tremors
INTERCOM FACILITY	: For communication from Flat to Flat & from Flat to Security Cabin and vice versa.



SCHEMES COMPLETED SINCE 2000

Completed projects at Nagpur

- Shree Apartments
- Meher Apartments
- Rachana Shelter
- Rachana Classic
- Rachana Mathura
- Rachana Gharkul
- Rachana Surabhi
- Rachana Vihar
- Rachana Midas
- Rachana Vatika
- Rachana Gokul
- Rachana Govind
- Rachana Angan
- Rachana Tarangan
- Rachana Madhuban
- Rachana Vishwa
- Rachana Jheel
- Rachana Srushti
- Rachana Lotus
- Rachana Galaxy
- Rachana Vrundavan
- Rachana Sahil
- Rachana Rutuparna

Completed projects at Pune

- Rachana Chaitraban
- Rachana Durvankur
- Rachana Zephyr

Projects under construction at Nagpur

- Rachana Sayantara
- Rachana Madhukosh



Launching soon: Rachana Sayantara Phase-II



Launching Soon: Rachana Anandvan